

## Installation

1. Clean the threaded area of the motor tube using *OMC Cleaning Solvent*.

7 2. Install motor tube seal into adapter. Apply *RTV adhesive sealant* to top of seal.

3. Spray *OMC All-Purpose Marine Cleaner* on the motor tube leads to provide lubrication.

4. Insert the leads into the motor tube.

8 5. Apply *Locquic Primer* then *OMC Ultra Lock* to the threads of the motor tube.

9 6. Tighten adapter on motor tube.

Note Align adapter set screw hole with existing dent in motor tube to maintain proper motor alignment.

10 7. Apply *OMC Screw Lock* to set screw and install. Tighten set screw to 30-40 in. lbs. (3,4-4,5 N·m).

8. Verify motor offset using the procedure on Page 4-10.

9. Install motor as follows:

Note When soldering is required, use a rosin core solder. Do not use an acid core solder.

11 ● Install a new O-ring (A) in groove of motor. Place spacer (B) over leads of motor.

● Slide heat shrink tubes (C) over red and green leads of motor.

● Connect adapter and motor red leads with splice (D). Crimp and solder splice.

● Connect black adapter lead to green motor lead with splice (D). Crimp and solder splice.

● Slide heat shrink tubes over splices, and shrink with a suitable heat source.

● Apply *OMC Nut Lock* to threads of motor retaining screws (E). Attach motor to adapter being careful not to pinch the leads. Tighten screws to a torque of 24-36 in. lbs. (2,8-4,0 N·m).

10. Install steering housing as described in **Section 3**.

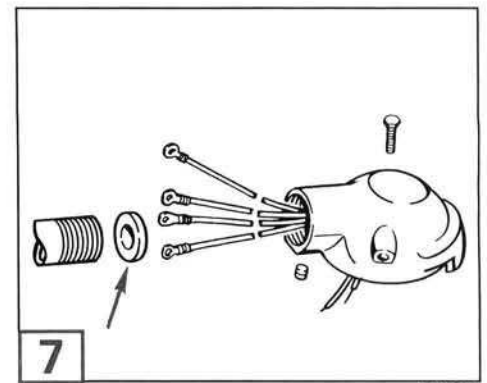

832027

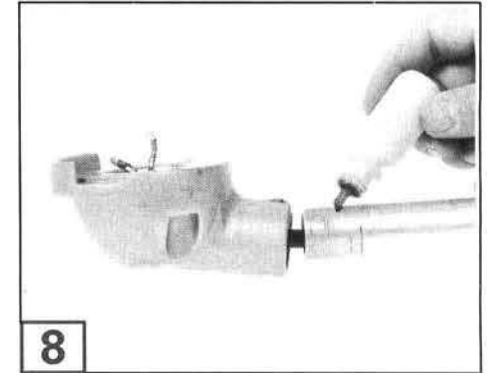

10989

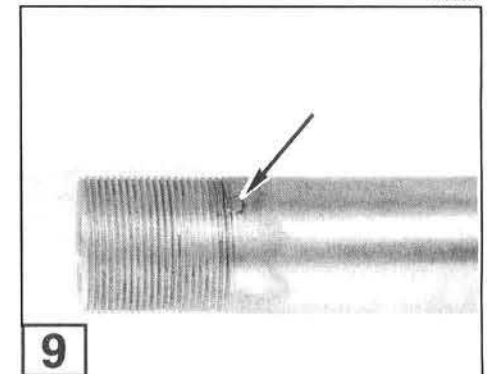

10990

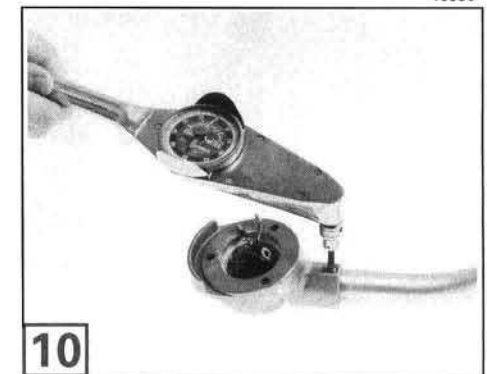

11074

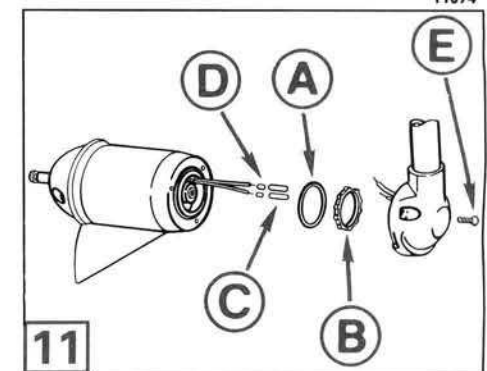

DR3681