

SLIDE SUSPENSION-TORQUE REACTION

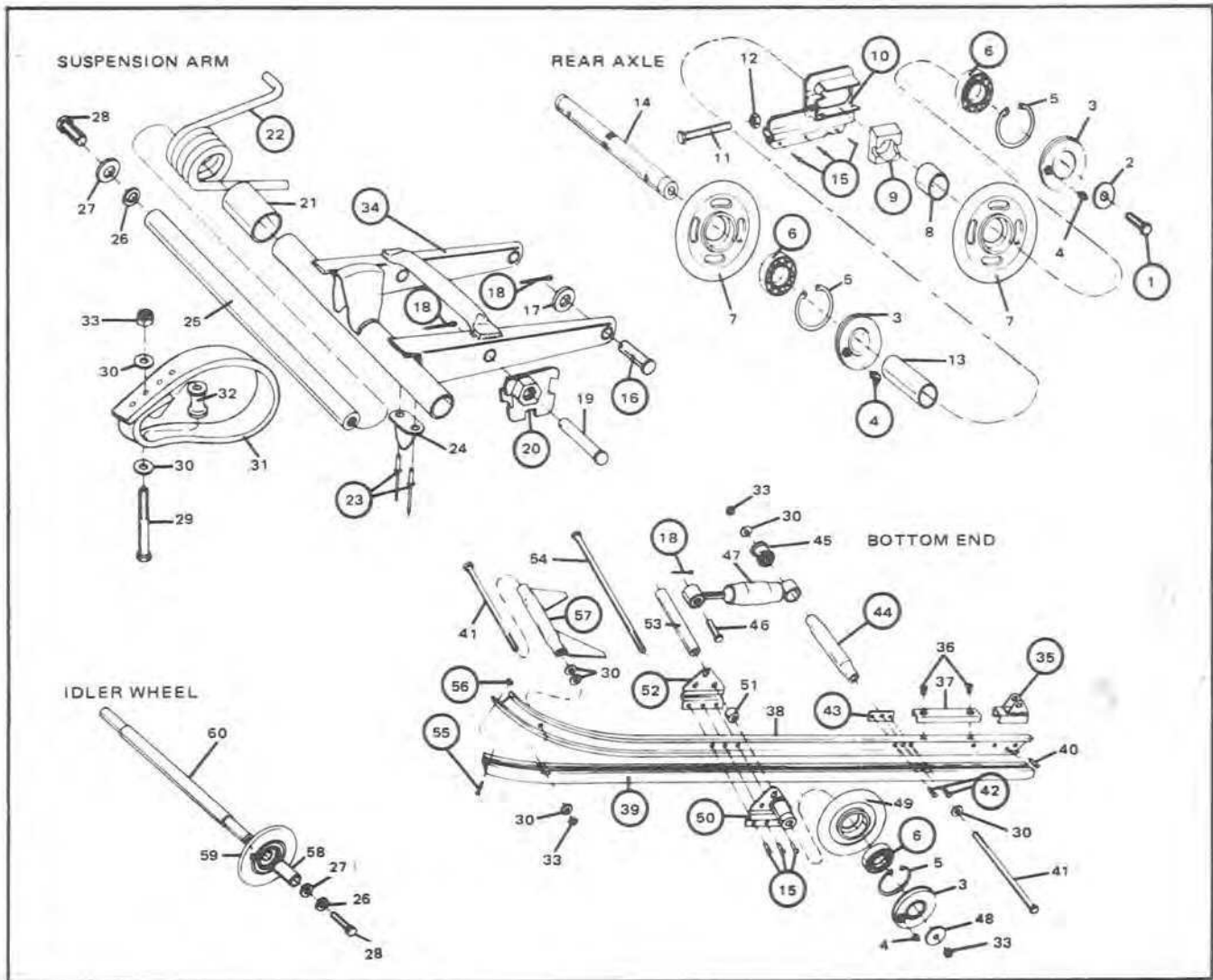

- | | | | |
|-------------------------|---------------------|----------------------------|----------------------------------|
| 1. Bolt. | 16. Clevis pin | 31. Stopper strap. | 46. Clevis pin. |
| 2. Washer. | 17. Washer. | 32. Spacer. | 47. Shock absorber. |
| 3. Cap. | 18. Cotter pin. | 33. Nut. | 48. Washer. |
| 4. Grease fitting. | 19. Clevis pin. | 34. Suspension arm. | 49. Idler. |
| 5. Circlip. | 20. Adjustment cam. | 35. Sliding support. | 50. Front arm support (outside). |
| 6. Ball bearing. | 21. Spring bushing. | 36. Pad retaining screw. | 51. Spacer. |
| 7. Idler wheel. | 22. Spring. | 37. Sliding pad. | 52. Front arm support (inside). |
| 8. Spacer tube (short). | 23. Pop rivet. | 38. Runner. | 53. Spacer. |
| 9. Sliding block. | 24. Stop bonding. | 39. Slider shoe. | 54. Through bolt (long). |
| 10. Adjustment plate. | 25. Cross shaft. | 40. Roll pin. | 55. Screw. |
| 11. Adjuster bolt. | 26. Washer | 41. Through bolt (short). | 56. Nut. |
| 12. Jam nut. | 27. Lock washer. | 42. Rivet. | 57. Front cross support. |
| 13. Spacer tube (long). | 28. Bolt. | 43. Reinforcement bracket. | 58. Spacer tube |
| 14. Rear axle. | 29. Bolt. | 44. Rear cross support. | 59. Idler wheel |
| 15. Rivet. | 30. Washer. | 45. Bushing. | 60. Cross Shaft |